

- Notes:-
- 1) All measurements in millimetres unless otherwise stated
 - 2) Existing plan layout produced from topographic survey completed by City Survey 2013
 - 3) Ramp and bridge modification proposal subject to Network Rail approval
 - 4) Ramp structures to be structurally independent from existing Network rail footbridge
 - 5) Proposal subject to planning permission approval
 - 6) Permanent closure of existing level crossing to be managed by Network Rail
 - 7) Ramp structures to be owned and maintained by Dorset County Council
 - 8) Intention to dedicate footbridge as public right of way subject to agreement with Network Rail

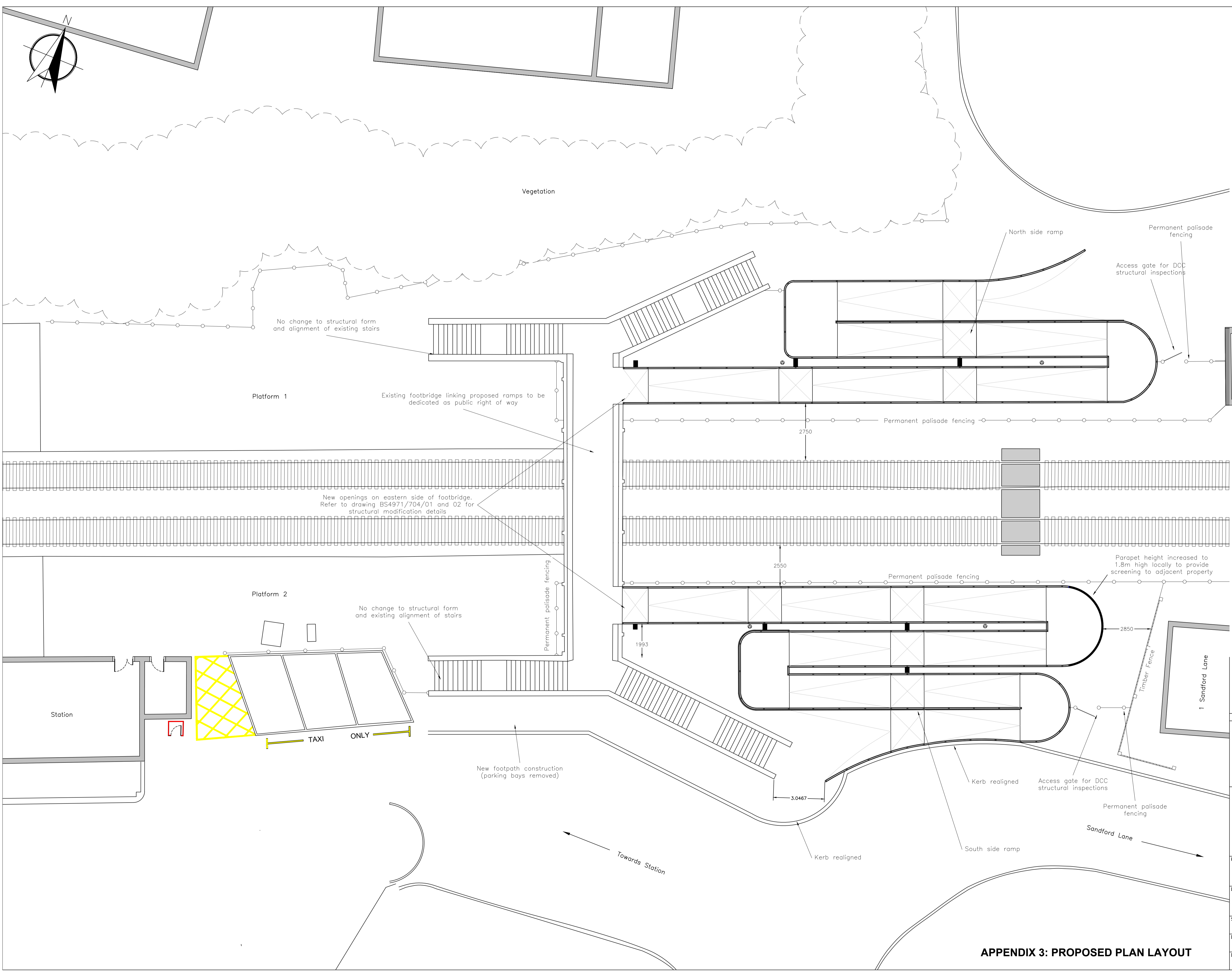

- Legend:-
- Ramp structural column/beam
 - ⊙ Lighting columns

Rev	Date	Issue / Remarks	Checked
B	May18	Screen added, remove barrier	MOG
A	Jul17	Changes to north ramp	MOG
Orig	Jun17		MOG

Dorset County Council
 ENVIRONMENT AND THE ECONOMY DIRECTORATE
 Mike Harries Director for Environment and the Economy

DORSET HIGHWAYS
 Andrew Martin
 Head of Dorset Highways

Project Title		
Wareham Access Ramps		
Drawing Title		
Proposed Plan Layout		
Scale (A1 Size)	Drawn By	Date
1:100	BL	12/04/2017
Drawing Number		
BS4971/701/01		
Drawing Status		
Planning Application		

APPENDIX 3: PROPOSED PLAN LAYOUT